



DIESEL ACCESSORIES, INC.

INSTRUCTIONS: CC2057 DIFFERENTIAL ADAPTER (FOR USE WITH CC2000 CLUTCH CADDY)

Install CC2057 Differential Adapter onto CC2000 Clutch Caddy as follows:

- 1.) Loosen 3/8-16 Set Screw in Clutch Caddy Pivot Block.
- 2.) Remove Clutch Holder Assembly and install CC2057-6 Adapter Plate into Pivot Block. ADAPTER PLATE MUST BE ALIGNED WITH CLUTCH CADDY LIFT ARM AS SHOWN BELOW. Tighten Set Screw.
- 3.) Loosely assemble CC2057-2 Rear Support Post onto Adapter Plate, so that it is free to pivot and slide.
- 4.) Thread one (1) CC2057-3 Stop Nut (tapered end up) down onto Rear Support Post.

To remove differential carrier:

- 1.) Loosen, but do not remove, differential carrier mounting bolts. Pry carrier away from housing approximately 3/16".
- 2.) Position Differential Adapter (mounted on Clutch Caddy) under differential carrier. Turn CC2057-4 Adjusting Screw until Adapter Plate is approximately parallel to differential carrier center-line. DO NOT USE IMPACT WRENCH ON ADJUSTING SCREW.
- 3.) Rotate differential yoke so that Rear Support Post may be inserted through both universal joint bores. (Note: Half-yokes must have end caps in place.) Raise Differential Adapter enough to thread remaining Stop Nut (tapered end down) onto Rear Support Post, thereby capturing differential yoke.
- 4.) Raise Differential Adapter until differential carrier flange rests approximately centered in groove (at Front Case Support).
- 5.) Turn both Stop Nuts until differential yoke is secured between them. Lock Rear Support Post in place by tightening 5/8-11 Hex Nut.
- 6.) Remove bolts attaching differential carrier to housing.
- 7.) Pull Clutch Caddy, with differential carrier attached, away from housing.

To install differential carrier:

- 1.) Support differential carrier from above.
- 2.) Raise Differential Adapter (mounted on Clutch Caddy) so that Rear Support Post may be inserted through both universal joint bores and differential carrier flange rests approximately centered in groove (at Front Case Support).
- 3.) Turn both Stop Nuts until differential yoke is secured between them. Lock Rear Support Post in place by tightening 5/8-11 Hex Nut.
- 4.) Position Adapter, with attached differential carrier, at the front of the housing. Adjust height using Clutch Caddy controls. Rotate differential carrier until mounting holes in flange and housing are aligned. Tilt differential carrier flange to match housing, using CC2057-4 Adjusting Screw. DO NOT USE IMPACT WRENCH ON ADJUSTING SCREW.
- 5.) Position differential carrier in housing and install mounting bolts. Remove CC2057 Differential Adapter before mounting bolts are completely tightened.

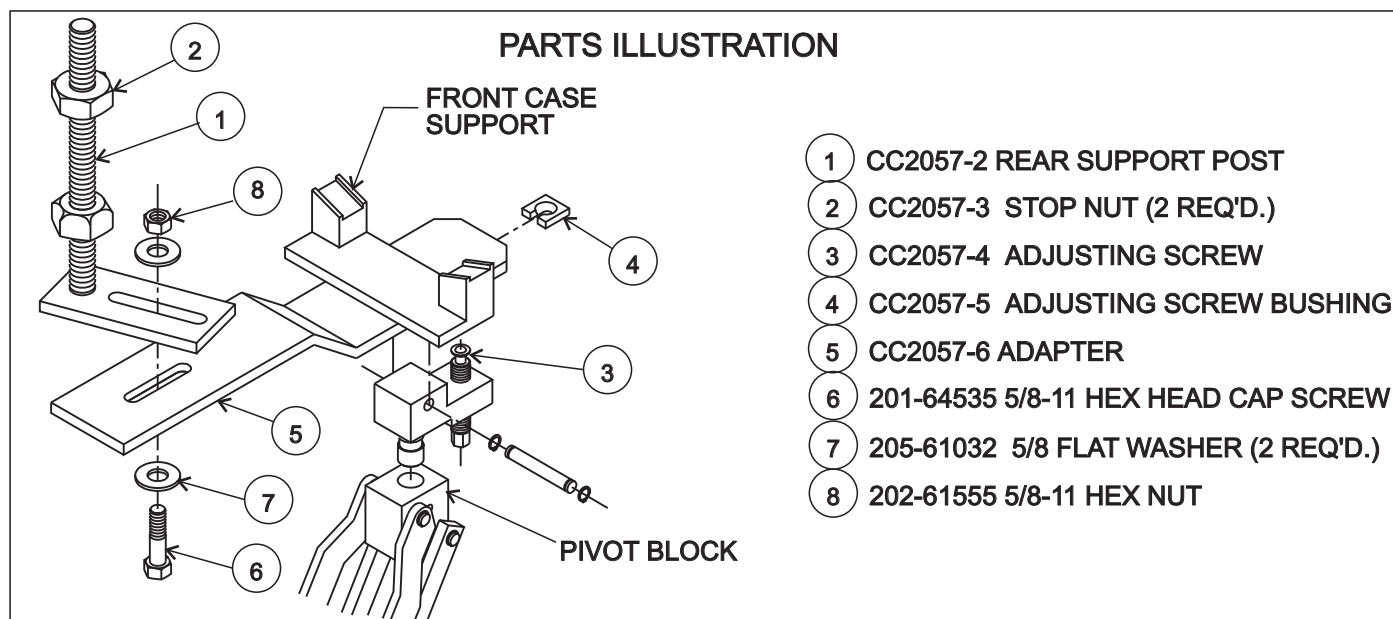

KIENE
DIESEL ACCESSORIES, INC.

WWW.UNIQUETRUCK.COM
616-531-8868

UNIQUE
TRUCK EQUIPMENT